

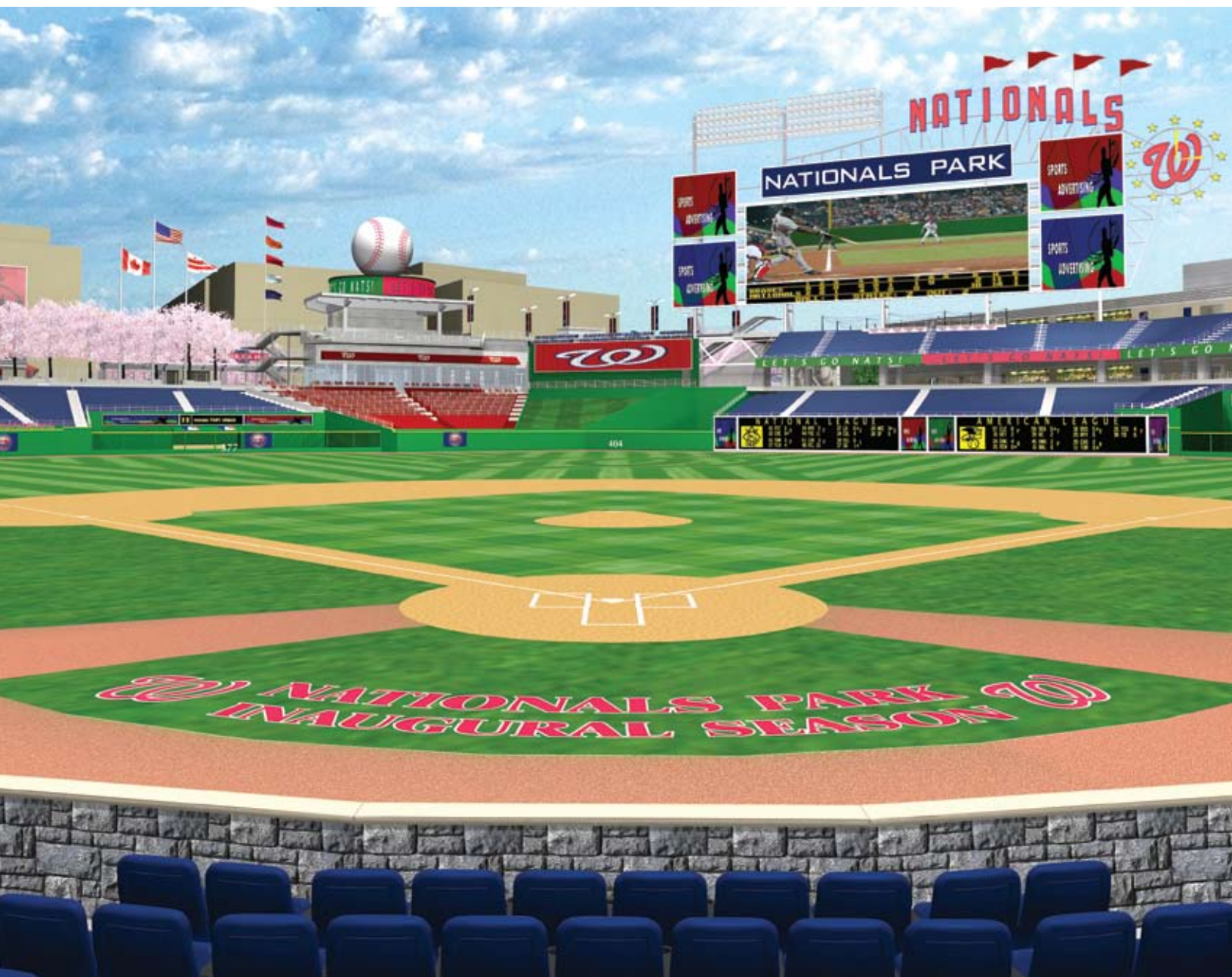

WELCOME HOME  
TO YOUR FIELD OF DREAMS





## WELCOME HOME TO YOUR FIELD OF DREAMS

The most spectacular ballpark in Major League Baseball opens its doors in April 2008. Nationals Park will embody the best features of other acclaimed MLB ballparks, yet will possess its own unique architecture and characteristics with a distinctive D.C. flavor, including cherry blossoms, an “Oval Office” bar and breathtaking views of the Capitol. Concourses will be spacious and open, with a panoramic view of the playing field. Nationals Park will feature a state-of-the-art high-definition video board and audio system as one of the many amenities to provide the ultimate fan entertainment experience.

The seating bowl will boast some of the best sightlines in baseball, with only 10,000 of the 41,222 seats in the upper deck and the majority of seats in the lower seating bowl, Club and Mezzanine levels. Seats down the lines will be angled toward the infield, with outstanding views of the field from every seat in the house. The ballpark will offer a wide menu of culinary offerings, with four restaurants and lounges, 18 permanent concession stands and many portable concession outlets that will present a variety of distinctive D.C. flavors, from Adams Morgan to Chinatown to the Chesapeake Bay to traditional ballpark fare.

This guide will provide the information necessary to help Season Ticket Holders indicate their preferences regarding seats in Nationals Park. Current Season Ticket Holders are being provided with priority status to secure seats. This guide will illustrate the process for relocating your seats and the different options available. These options include opportunities for Full Season Ticket Holders, Half and Partial Season Ticket Holders as well as Premium Seating offerings. All premium seats are located within the Infield Skin.

In order to assist you with your seat relocation preference, this guide includes seating diagrams and maps of Nationals Park, along with detailed ticket plans, pricing and benefits that accompany the various seating categories in Nationals Park.

After reviewing the guide, Season Ticket Holders should complete the Relocation Questionnaire located in the back pocket. Please submit it with the deposit amount indicated and return it to the Washington Nationals ticket office prior to the July 13, 2007 deadline in the self-addressed, stamped envelope provided. Or you can submit your Questionnaire and payment online by going to [nationals.com/relocation](http://nationals.com/relocation) and following the steps that are outlined there for you.

If you need assistance completing your Questionnaire, please contact the Nationals Sales and Service Department at 202.675.NATS (6287).

Thank you for supporting the Nationals, and we look forward to seeing you at Your Field of Dreams in 2008!

Stan Kasten  
President  
Washington Nationals Baseball Club



***Hey Nats Fans – July 13, 2007, is the deadline to add new season tickets to your 2007 Nationals account. All season tickets ordered and paid in full by this date will be relocated at the time of your original class date. Please contact a member of our Season Ticket Sales Department by calling 202.675.NATS and place your order today!***



# TABLE OF CONTENTS

I. Overview of Relocation Process .....	2-6
a. Relocation Philosophy	
b. Definitions	
c. Priority Relocation Process	
II. Season Ticket Allotment .....	7
III. Ballpark Architectural Overviews and Features .....	8-11
a. Seating Bowl Configuration	
b. Comparison to RFK Stadium	
c. Nationals Park "Tale of the Tape"	
IV. Premium Seating .....	12-15
a. Suites	
b. Presidential Seats	
c. Diamond Seats	

V. Club Seats and Traditional Seating .....	16-17
a. Club Seats	
b. Traditional Seats	
VI. Seat Selection Process and Deposit Information .....	18
VII. Nationals Park Pricing Guide and Seating Diagram .....	19
VIII. Suite Design Information .....	20
IX. Ballpark Parking and Transportation .....	21
X. Frequently Asked Questions .....	22-24



## OVERVIEW OF THE RELOCATION PROCESS

This Relocation Guide is a comprehensive resource for Nationals Season Ticket Holders with respect to the relocation process to Nationals Park. This guide explains how the priority status has been established. Included in this guide are the relocation philosophy, seating map and price charts, which can assist you in making informed decisions with respect to your relocation preference.

More than 90% of the seats in Nationals Park are Traditional Seats (non-premium seats that do not require a multi-year commitment). Dugout Box seats and Baseline Box seats are a popular location that is close to the field with outstanding views of the action that remain Traditional Seats.

Less than 10% of the seats in Nationals Park are Premium Seats. The three levels of Premium Seating and Suites are located within the Infield Skin, offering an enhanced level of amenities, services, comfort and convenience that were unavailable at RFK Stadium. The Presidential Seats (the first 10 rows directly behind home plate), the Diamond Seats (located just behind the Presidential Seats) and the Suites are sold on a multi-year basis. The Club Seats, located just below the Club Suite Level, are sold on an annual basis. All of the Premium Seating is described in depth in the Premium Seating section of this guide.

Most importantly, this guide presents information for the relocation process, which will be conducted chronologically based on how many consecutive years current customers of record have renewed their season ticket accounts. We have broken down the relocation process into classes that indicate which year you purchased your season tickets. It is very important that you know to which annual class you belong: Class of 2005, 2006 or 2007. Your class is the first year you established a season ticket account and kept it in good standing by renewing annually without interruption. The Relocation Questionnaire located in the back jacket cover will include your class as well as your current account number. Please make note of these two important items in all of your communication and correspondence with the Nationals staff.

We have tried to anticipate and answer questions that will be frequently asked about the relocation process in the FAQ (Frequently Asked Questions) section of this guide. All the information in this guide can be accessed on the Nationals website ([nationals.com/relocation](http://nationals.com/relocation)) or click on "Tickets" and select "Relocation". You may submit your Questionnaire and deposit online through the website by accessing the Relocation section of the Nationals website. Please preview the "Virtual Video" tour on our website and the 3-D views of specific seat locations to assist you in the seat selection survey preferences.

At the time you submit your Questionnaire, we ask that you place a nominal per-seat, non-refundable, non-transferable deposit to guarantee your seats in Nationals Park. For Club and Traditional Seats, the amount of the deposit is based on the type of Season Ticket plan that you have chosen. Premium Seating locations will require a deposit that is a percentage of the total cost of the season ticket package. Deposit information for these seats is outlined in greater detail in the Premium Seating section of this guide.

If you have any questions, you can contact a member of our Sales and Service staff at 202.675.NATS (6287) or via email at [STComments@nationals.com](mailto:STComments@nationals.com). We look forward to helping you relocate your seats to the best ballpark in Major League Baseball!

***This Season Ticket Relocation Guide and Questionnaire is a statement of general policy. It does not create contractual benefits or obligations or any legal rights whatsoever. The Nationals reserve the right to amend or modify the relocation policy with or without notice to Season Ticket customers and to depart from the relocation policy in specific circumstances at the Nationals' sole discretion. The Nationals reserve the right to amend or modify any physical aspect or amenities of Nationals Park described herein with or without notice to Season Ticket customers. Season Ticket purchases are subject to approval by the Nationals and may be refused at the Nationals' sole discretion.***



## RELOCATION PHILOSOPHY

The foundation of every sports franchise is the long-term support of its Season Ticket Holders. Therefore, the Nationals have determined that the primary factor in establishing priority in the relocation from RFK Stadium to Nationals Park will be account longevity (based on the number of continuous years that a customer of record has maintained a season ticket account in good standing).

The guiding philosophy in formulating the relocation process has been to reward Season Ticket Holders for their loyalty since the Nationals' inception in Washington, DC in 2005.

Nationals staff members have visited other new ballparks to research the best programs and develop best practices, policies and procedures for the Nationals Ballpark and our Season Ticket Holders, the lifeblood of our franchise.

Outlined to the right are the criteria we have established to facilitate the priority relocation process.

### I. Primary priority criteria

- a. Account Longevity – the year the season ticket account was established and has been maintained in good standing.

### II. Secondary criteria

- a. Ticket plan size – the number of games within a season ticket plan.
  - i. Full Season – a season ticket plan that includes all regular- season home games and any potential home exhibition games.
  - ii. Half Season – a season ticket plan that includes 41 home games.
  - iii. Partial Season – a season ticket plan that includes 20 home games.
- b. Seating Category – the name of the seating category you purchased at RFK Stadium: Diamond Club, Field MVP, etc.
- c. Initial date and time of purchase.



## DEFINITIONS

**Account Longevity** – The number of years a customer of record has continuously maintained a Nationals Season Ticket Holder account in good standing.

**Center Field Lounge Seats** – Located behind the Center Field wall in front of the Center Field Restaurant and Bar. These seats include a non-cumulative \$20 food and beverage credit per ticket per game and do not require a multi-year agreement.

**Class** – The class to which a Season Ticket Holder belongs is the first year the official Customer of Record established a season ticket account that has been renewed annually without interruption.

**Club Seats** – Located behind home plate on the Club level within the Infield Skin. The Club seats have access to the 33,000 square foot Stars and Stripes Club and do not require a multi-year agreement.

**Customer of Record** – The name of the Season Ticket Holder that is listed on the account with the Nationals. This is the person or company that receives all of the official correspondence that is sent out by the Club. Season ticket accounts are non-transferable.

**Deposit** – The nominal amount required to be submitted to the Nationals by the current Customer of Record to secure seat requests in Nationals Park in 2008. Deposits are non-refundable and non-transferable.

**Diamond Seats** – Located in the 15 rows behind the Presidential Seats and behind home plate, with access to the Nationals Club, the Diamond Seats include a non-cumulative \$35 food and beverage credit per seat per game, and require a three-, five- or seven-year commitment.

**Disabled Seating** – Seating areas that accommodate a wheelchair and a companion seat, located on an open, level space that has a smooth, stable and slip-resistant surface. A companion seat is a conventional seat that accommodates a friend or companion of the patron in a wheelchair.

**Full Season Ticket Plan** – A season ticket plan that includes all regular-season home games and any potential home exhibition games.

**Half Season Ticket Plan** – A season ticket plan that includes 41 home games. Upon release of the 2008 schedule, Half Season plan holders will receive our pre-determined 41-game plan, which will include specific game dates and opponents.\*

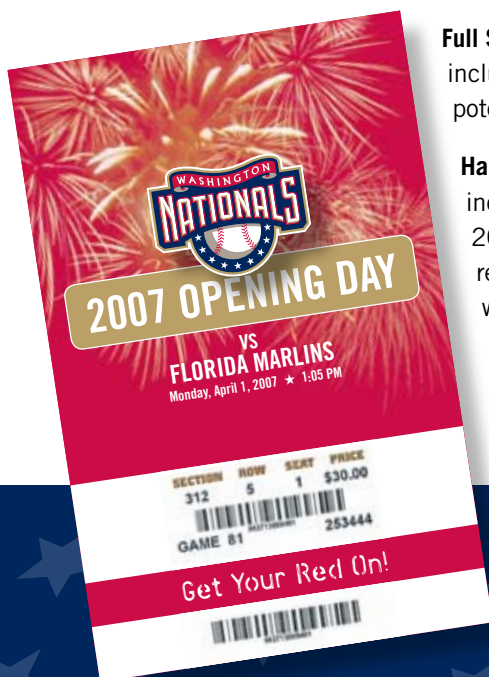



**In Good Standing** – An account that has been paid in full for the 2007 season.

**Partial Season Ticket Plan** – A season ticket plan that includes 20 home games. Upon release of the 2008 schedule, Partial Season plan holders will have the opportunity to choose between one of two pre-determined partial plans, Plan A or B, which will include specific game dates and opponents.\*

**Partners** – Individuals other than the official customer of record who are listed on a Season Ticket account solely to authorize them to 1) Pick up tickets or other items (e.g. parking) that have been pre-approved by the customer of record; 2) Obtain replacement seat passes (for example, to replace lost or stolen tickets).

**Premium Seating** – Seats in Nationals Park located in designated sections with accompanying amenities, membership privileges and services, such as club or lounge access, special parking areas or entrances, concierge services, “members only” special events and, in some cases, food and beverage credits. All Premium Seating levels require a multi-year commitment.

**Presidential Seats** – Located in the first 10 rows behind home plate with access to all clubs and lounges, including the prestigious President’s Club, which includes a complimentary, all-inclusive gourmet buffet (alcoholic drinks not included), and requiring a three-, five- or seven-year commitment.

**Priority** – Determines the order in which current Season Ticket Holders will be relocated to Nationals Park. Priority is first determined by account longevity (Class), then by plan size (number of games), seating category and date and time of the original purchase. Customers of record with the highest priority will be accommodated first, in accordance with the guidelines and preferences stated in their Relocation Questionnaire.

**Season Ticket Plan** – The number of games you wish to purchase in Nationals Park. A Full Season Plan includes all regular-season home games and any potential home exhibition games; a Half Season Plan has 41 games and a Partial Plan has 20 games.

**Seating Category** – The name of the seating category you purchased at RFK Stadium in 2007:  
Diamond Club, Field MVP, Loge MVP, Field Box, Terrace MVP, Loge Box, Terrace Box, Terrace,  
Lower View MVP, Loge Outfield, Upper View MVP, Lower View Box, Upper View Box,  
Lower View Outfield, Upper View Outfield.

**Traditional Season Tickets** – Seats in Nationals Park that do not come with Premium Seating amenities and/or multi-year lease terms.

\*The number of games in Half and Partial Season Ticket Plans is subject to change.

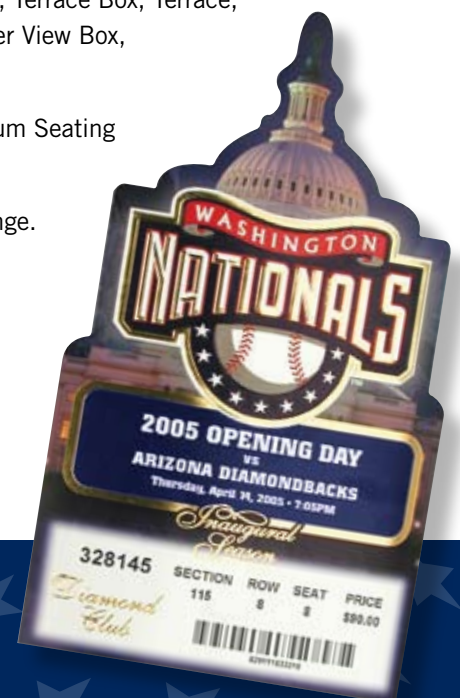

## PRIORITY RELOCATION PROCESS

**A. Account Longevity** – The priority for relocation will be determined first by account longevity (the year the season ticket account was established and the number of continuous years that a customer of record has maintained a season ticket account in good standing).

**B. Plan Size** – Full Season Ticket Holders in the same class (year of account origination) will have priority over Half Season Ticket Holders, and Half Season Ticket Holders will have priority over Partial Season Ticket Holders. The same criteria will apply to Half Season and Partial Season Ticket Holders respectively, after the Full Season Ticket Holder accounts have been relocated.

**C. Seating Category** – Many customers of record will have identical account longevity and plan size; therefore the next criteria for determining priority will be based on the category of account at RFK Stadium. Outlined below is the priority status order for each account category, with Diamond Club Season Ticket Holders receiving the highest priority (from RFK Stadium):

- I. Diamond Club
- II. Field MVP
- III. Loge MVP
- IV. Field Box
- V. Terrace MVP
- VI. Loge Box
- VII. Terrace Box
- VIII. Terrace
- IX. Lower View MVP
- X. Loge Outfield
- XI. Upper View MVP
- XII. Lower View Box
- XIII. Upper View Box
- XIV. Lower View Outfield
- XV. Upper View Outfield

**D. Date and Time** – Among customers of record with the identical priority criteria outlined above, the final criteria for priority will be the date and time the account was established.

**E. Half and Partial Season Ticket Plans** – The same criteria outlined above for all Full Season Ticket Holders will apply to Half Season and Partial Season Ticket Holders respectively, after the Full Season Ticket Holder accounts have been relocated.





## SEASON TICKET ALLOTMENT

**A. Season Ticket Allotment** – Season Ticket Holders will be able to purchase the same number of season tickets as they have in their 2007 season ticket account. For example, if a Season Ticket Holder purchased four seats in 2005 and added two more seats prior to July 13, 2007—they would be eligible to purchase six season tickets at Nationals Park based on their original date of purchase. Any season tickets added to an account after July 13, 2007 will be assigned seats in Nationals Park at the end of the Class of 2007 and prior to the new seats purchased by the Class of 2008.

**B. Premium Seating Allotment** – The exception to the above policy pertains to Premium Seating purchases. Nationals Park has five times the amount of Premium Seating as RFK Stadium. Therefore, Season Ticket Holders who would like to purchase Premium Seats may do so in addition to or in lieu of their Traditional Season Tickets, based on availability. Please note that Presidential Seat purchases will be limited to four seats per Full Season Ticket account.

**C. Half and Partial Season Ticket accounts (41 and 20 games) upgrading to larger ticket plans** – Half and Partial Season accounts upgrading to a Full Season Ticket Plan will be seated after the renewing Full Season Ticket accounts, in their class, have been seated. Partial Season Ticket accounts upgrading to a Half Season Ticket Plan will be seated after the renewing Half Season Ticket accounts, in their class, have been seated.

**D. Group Seating** – Customers of record who wish to have their seat locations adjacent to or near other Season Ticket Holders may request to do so, but please note that this preference may compromise your location or may not be possible depending on the preferences of other Season Ticket Holders.

**E. Comparable seating to RFK Stadium** – Every effort will be made to accommodate current Season Ticket Holders in the most desirable seats in Nationals Park in accordance with these guidelines and the preferences specified on your Relocation Questionnaire. However, the configuration of Nationals Park is quite different and much better for viewing baseball than RFK Stadium, so in some cases it may not be possible to relocate Season Ticket Holders to equivalent or comparable seat locations.



## BALLPARK ARCHITECTURAL OVERVIEW AND FEATURES

### **Design:**

Nationals Park will be located in Southeast Washington, south of the Capitol, along the fast-developing waterfront district adjacent to the Navy Yard. The new park not only redefines modern sports facility architecture but also serves as the catalyst and cornerstone of a new mixed-use waterfront district in our nation's capital. The exterior façade of the 41,222 seat venue features an innovative design of steel, glass and pre-cast concrete to create a facility that uniquely reflects the architecture of Washington, DC. The concourses and seating decks are configured to create a variety of distinct neighborhoods, each with its own identity and viewing experience. As fans traverse the Ballpark's vertical circulation ramps throughout the various levels of the facility, they will witness panoramic views of the waterfront, Navy Yard, the surrounding city and landmarks such as the Capitol and the Washington Monument.

### **Cutting-Edge Game Presentation and Fan Experience:**

Nationals Park will be equipped with state-of-the-art video and audio technology, including a 4,500 square foot high-definition scoreboard, as well as over 600 linear feet of LED ribbon board along the inner bowl fascia. In addition, the new ballpark will feature a variety of entertainment and fan-interactive alternatives to ensure a compelling and engaging game entertainment experience.

### **Green Design:**

Nationals Park will strive to become the first major stadium in the United States accredited as a **Leadership in Energy and Environmental Design (LEED)** Green Building Rating System™ certified ballpark. The new ballpark will pay particular attention to issues affecting the health of the Anacostia River, such as stormwater management and minimization of water pollution.





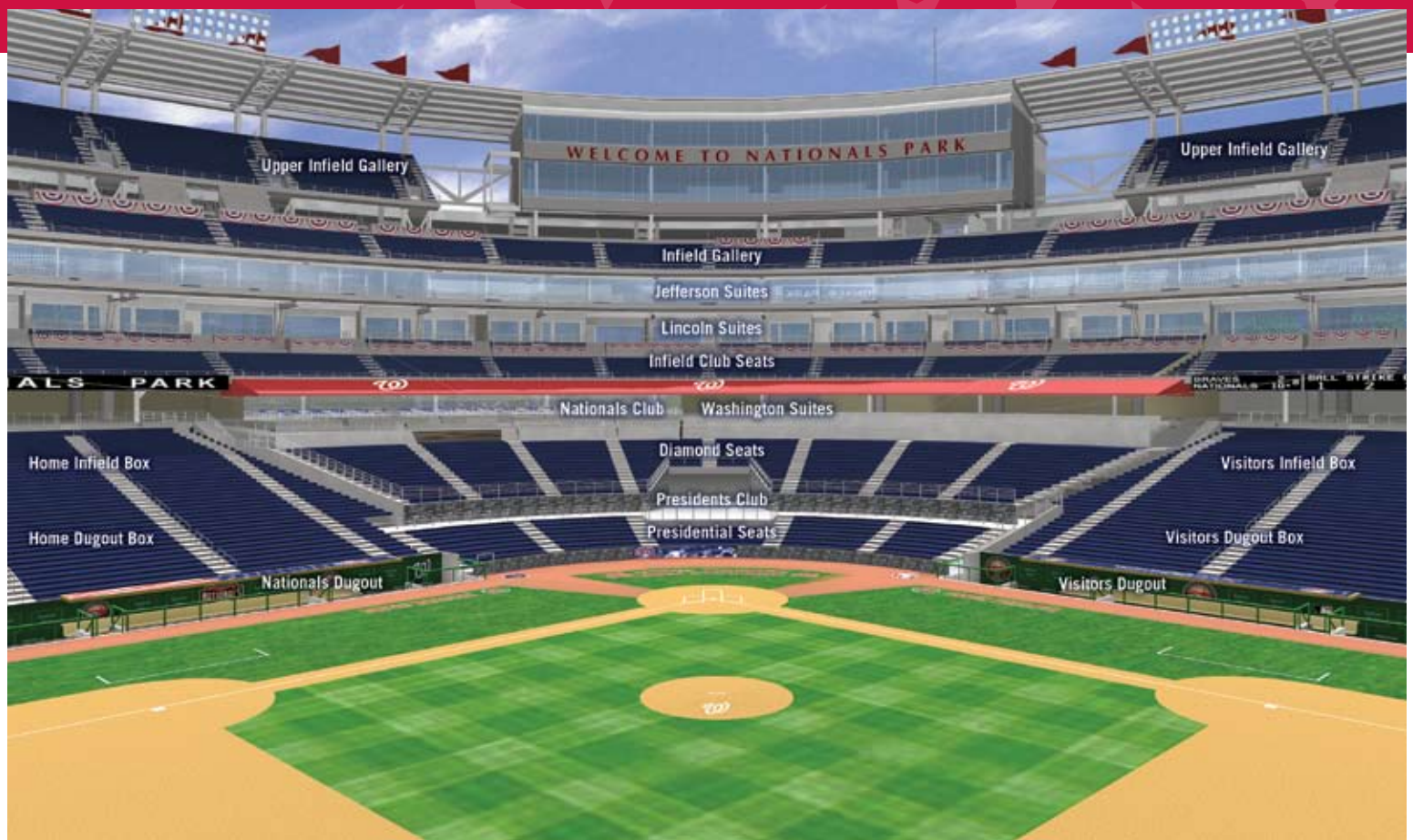



## COMPARISON TO RFK STADIUM

### Site Plan Comparison

1. Nationals Park's asymmetrical playing field geometry is intended to create more exciting plays compared to the symmetrical field of RFK.
2. Nationals Park's orientation affords wonderful views of the Capitol, Washington Monument and Washington, DC.
3. The new ballpark is the redevelopment catalyst for much of the Southeast area.
4. Nationals Park is much more transparent on the main concourse which allows views into the playing field at selected locations due to concessions and restrooms located on the outer walls of the venue.
5. Access into and from Nationals Park is from all sides.
6. The sunken field at Nationals Park allows easier access to field-level seating.

RFK Stadium

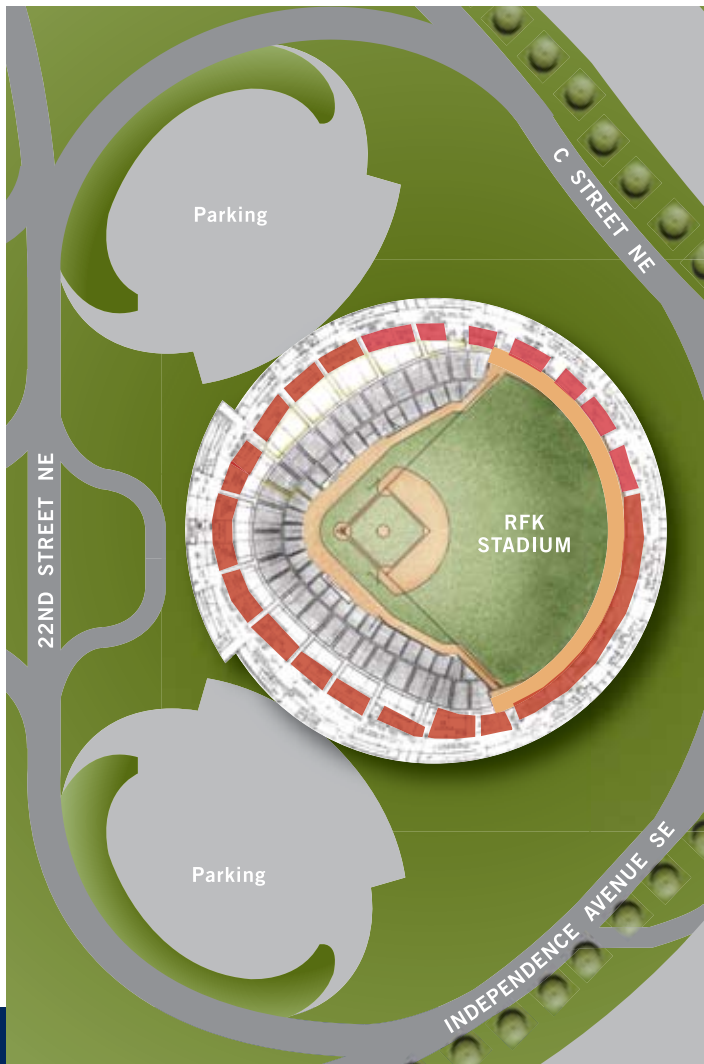

Nationals Park

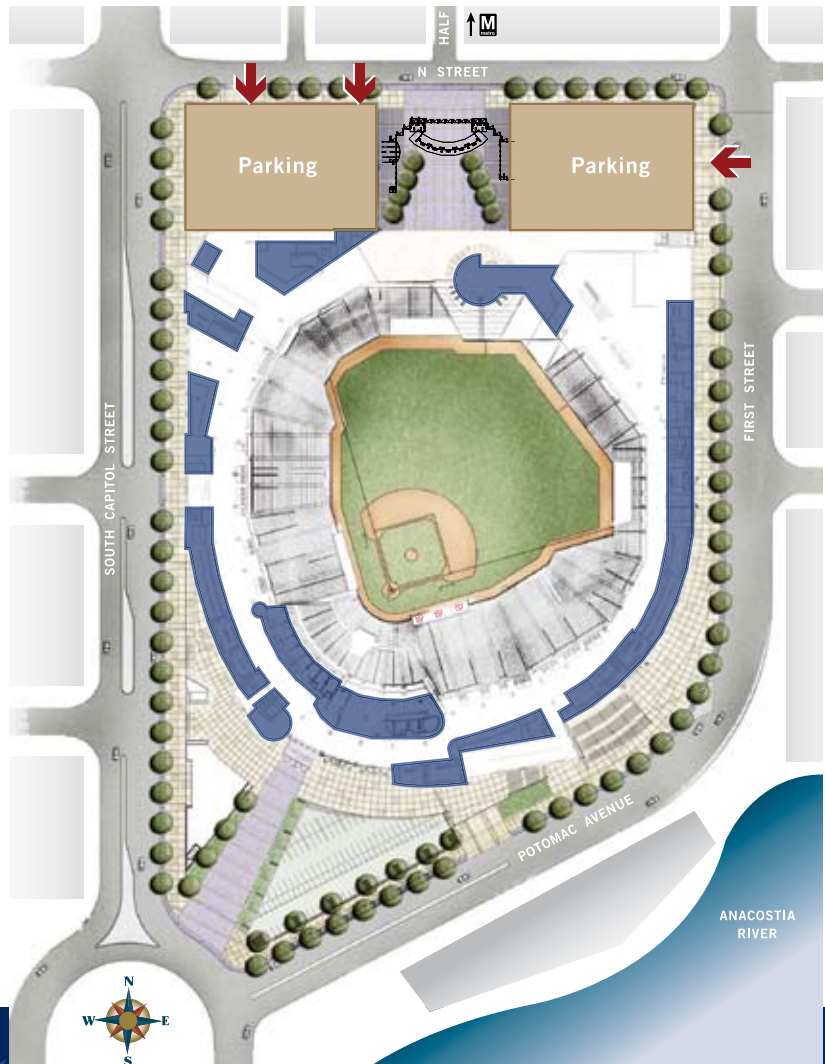



Nationals Park		vs.	RFK Stadium	
Total Capacity				
41,222			46,000	
Field Dimensions				
Left Field	336 ft		Left Field	335 ft
Left Center	377 ft		Left Center	380 ft
Center Field	403 ft		Center Field	410 ft
Right Center	370 ft		Right Center	380 ft
Right Field	335 ft		Right Field	335 ft
Average Concourse Width				
Main Level	40 ft		Main Level	19 ft
Club Level	26 ft		Mezzanine Level	20 ft
Upper Level	30 ft		Upper Level	15 ft
Concessions – point of sale				
181			102	
Restaurants (square footage)				
4 Clubs	64,200 sf		Diamond Club	8,900 sf

Nationals Park		vs.	RFK Stadium	
Cupholders				
41,222			0	
Legroom between rows				
33" to 42"			26"	
Disabled Seats				
853			448	
Vertical Transportation				
Escalators	8		Escalators	0
Elevators	7		Elevators	1
Permanent Ticket Windows				
33			10	
Team Stores				
3 stores			1 store	
Scoreboard Dimensions				
4,532 sf			1,376 sf	

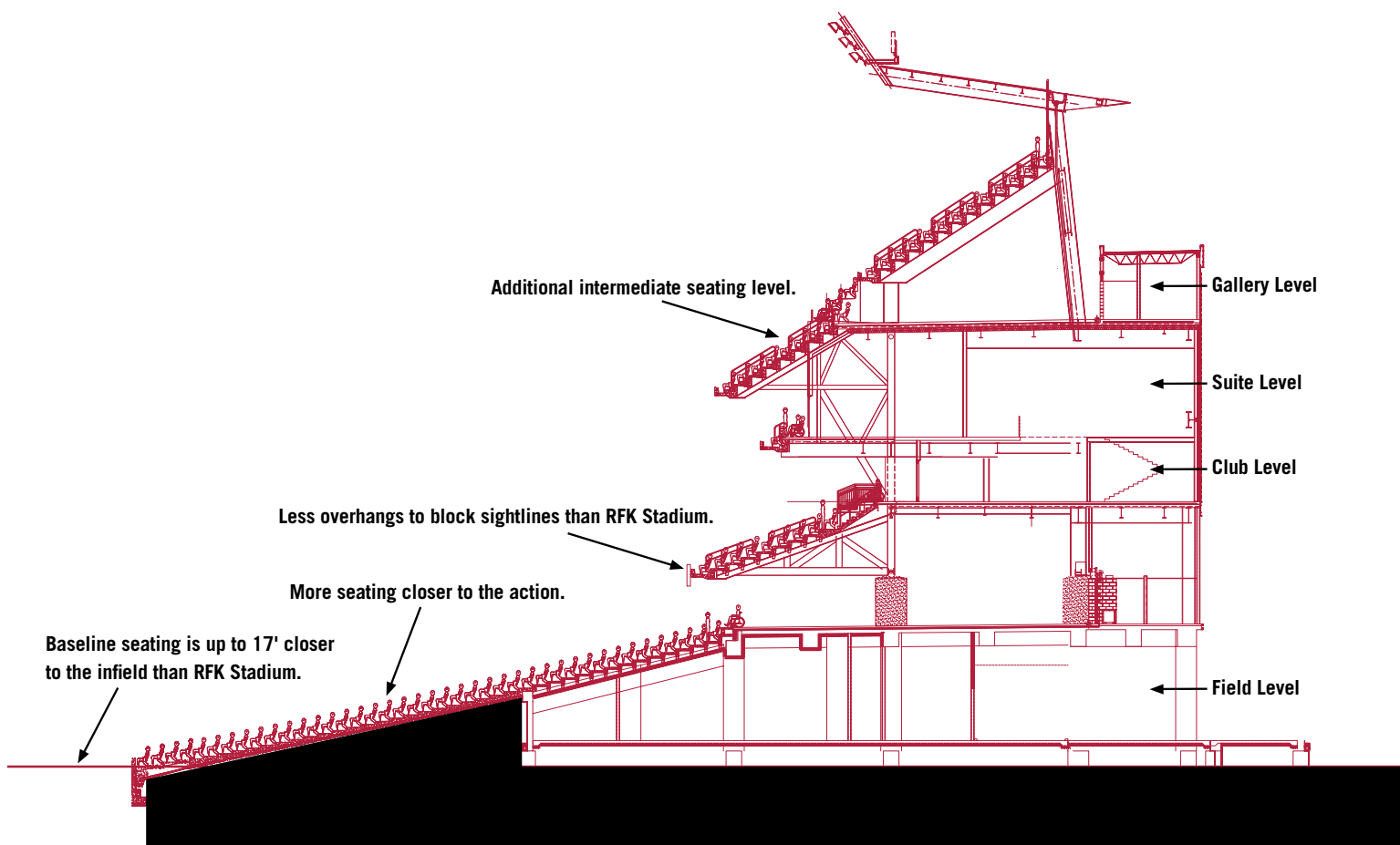

## PREMIUM SEATING INFORMATION

The Premium Seating areas of Nationals Park consist of three levels of seating—Suites, Presidential Seats and Diamond Seats.

### SUITES

Today's leaders in business, government and entertainment will enjoy the national pastime in the suites named after three of America's most exalted leaders: Washington, Lincoln and Jefferson. Unlike other ballparks, all of our 66 suites will be situated within the Infield Skin, delivering a baseball experience at the highest level. The result: simply the best sightlines in baseball.

#### Features and Benefits:

- **Washington Suites** – In these eight suites, there are 23 to 29 permanent seats. They are located on the Main Level concourse and are approximately 28' above the playing field, and include access to the Nationals Club and the Stars and Stripes Club.
- **Lincoln Suites** – Situated just above the Club Seats, these 22 suites are approximately 52' above the playing field and are located on the Club Level concourse, and have 16 to 22 permanent seats. Lincoln Suite Holders have access to the Stars and Stripes Club.
- **Jefferson Suites** – The 36 Jefferson Suites, which span first base through third base, are approximately 64' above the playing field and are located on the Suite Level concourse, and have 15 to 19 permanent seats. Jefferson Suite Holders have access to the Stars and Stripes Club.

#### All Suites have the following Benefits and Amenities:

- Four parking passes in Nationals Park parking garage
- In-game concierge service
- Wireless Internet access
- Flatscreen HDTV monitors
- Year-round suite access
- Complimentary game programs and stats delivered to your suite and a Nationals Yearbook will be sent during the season
- Playoff tickets priority
- Opportunity to purchase seats for other events prior to public sale
- Discount on Nationals merchandise
- Exclusive Suite Holder events
- Personal account manager

If you are interested in suite pricing and information at Nationals Park, please contact a member of our Premium Seating Department by calling 202.467.2008.

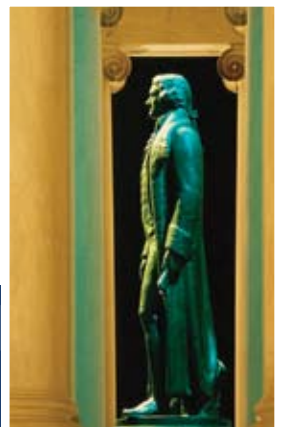



WASHINGTON SUITE

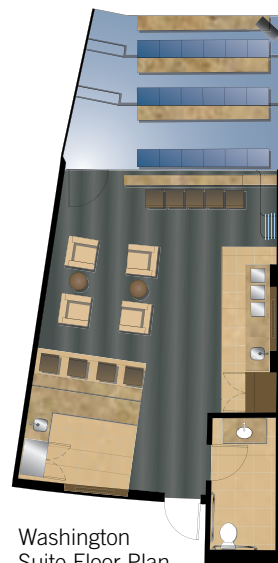

Washington Suite Floor Plan

LINCOLN SUITE



Lincoln Suite Floor Plan

JEFFERSON SUITE

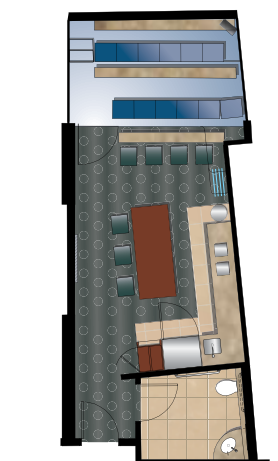

Jefferson Suite Floor Plan

## PRESIDENTIAL SEATS

Presidential Seats are the premier baseball experience and the top tier in a host of Premium Seating options in Nationals Park. Only 500 members (Season Ticket Holders) will have access to the prestigious President's Club and Presidential Seats, which boast the best sightlines in the Ballpark. Located in the first 10 rows, just 12 feet above home plate, this upscale section offers padded Presidential Seats just steps from the action. Inside the President's Club, members will enjoy sophisticated comfort, exceptional service and enhanced amenities, every game highlighted by a complimentary gourmet buffet (along with non-alcoholic beverages) amidst the elegance of a white tablecloth setting. Before and after the game, President's Club members will celebrate at the Oval Office Bar, where a full array of cocktail options will have them feeling like the Commander-in-Chief. Two window walls offer an insider's view of the home batting cage and press conference room. With an elegant atmosphere, delectable dining, and premier sightlines to see all the action, the Presidential Seats will be the most exclusive tickets in town.

### Features and Benefits:

- Limited to only 500 seats
- One parking pass in Nationals Park garage for every two seats
- All inclusive gourmet buffet including non-alcoholic beverages
- Complimentary in-seat food and beverage service
- Access to the President's Club, Nationals Club and Stars and Stripes Club
- Private restrooms within the President's Club
- Seats average 22" in width with a padded seat and back
- Complimentary game programs and game stats available in the Club and a Nationals Yearbook sent during the season
- Opportunity to purchase playoff tickets
- Opportunity to purchase seats for other events prior to public sale
- Exclusive Presidential Seat Holder events
- Personal account manager
- Plus all other amenities afforded to our traditional Season Ticket Holders

### Terms and Conditions:

All Presidential Seats are priced at \$300 per ticket per game, with the exception of the first row of seating. These seats require a multi-year lease agreement with a deposit of 20% of the total cost of the 2008 season tickets to secure the seats:

- Three-year license agreement: includes a 6% escalation in years 2 and 3
- Five-year license agreement: includes a 4% escalation in years 2–5
- Seven-year license agreement: includes a 2.5% escalation in years 2–7



The Presidents Club

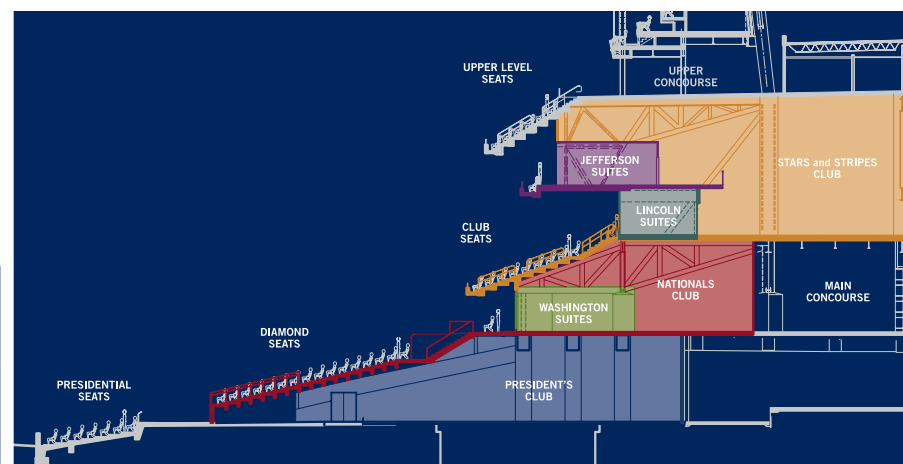



## DIAMOND SEATS

The Diamond Seats are located directly behind home plate, between the dugouts in the 15 rows behind the Presidential Seats with some of the best sightlines in the ballpark. Diamond Seat Season Ticket Holders have access to the Nationals Club, a classic baseball-inspired restaurant that captures the heritage of our national pastime and celebrates Washington's baseball history—showcasing the Senators and the Homestead Grays. The Nationals Club features a baseball-themed atmosphere including a replica of a scoreboard from the 1924 World Series, green padded outfield walls and ash baseball bats at the drink rail to enhance the “old time” baseball feel and flavor. The outdoor patio looks directly over the infield and is the perfect perch to catch a quick bite as well as the occasional foul ball. Diehard baseball fans will find it hard to leave this tribute to our national pastime.

### Features and Benefits:

- Limited to only 1,300 seats
- One parking pass in Nationals Park garage for every four seats
- Private entry into the Nationals Club from the main concourse
- A \$35 food and beverage credit per ticket per game
- In-seat food and beverage service
- Panoramic views of the playing field throughout the restaurant
- Exterior patio seating with view of playing field
- Access to the Nationals Club and Stars and Stripes Club
- Private restrooms within the Nationals Club
- Seats average 21" in width with a padded seat and slat back
- Complimentary game programs and game stats available in the Nationals Club and a Nationals Yearbook sent during the season
- Opportunity to purchase playoff tickets
- Opportunity to purchase seats for other events prior to public sale
- Exclusive Diamond Seat Holder events
- Plus all other amenities afforded to our traditional Season Ticket Holders

### Terms and Conditions:

All Diamond Seats are priced at \$150 per ticket per game and require a multi-year lease agreement with a deposit of 20% of the total cost of the 2008 season tickets to secure the seats:

- Three-year license agreement: includes a 6% escalation in years 2 and 3
- Five-year license agreement: includes a 4% escalation in years 2–5
- Seven-year license agreement: includes a 2.5% escalation in years 2–7



The Nationals Club

View from Presidential Seats



View from Nationals Club



## CLUB SEATS AND TRADITIONAL SEATING

Over 90% of seats in Nationals Park are Traditional Seats—that is, seats that do not require a multi-year commitment. This category also includes the Club Seats. These seats offer many amenities and benefits, such as a private club and padded seats, but also do not require a multi-year commitment.

## CLUB SEATS AND THE STARS AND STRIPES CLUB

Located within the Infield Skin will be approximately 2,700 Club Seats with a panoramic view of the playing field. The Club Seats at Nationals Park provide the best of both worlds: club seat amenities without a multi-year commitment. Club Seat holders will enjoy the 33,000 square foot Stars and Stripes Club, which features an expansive two-story club environment overlooking the waterfront on one side and the playing field on the other. A variety of culinary offerings will serve our guests, featuring sauté and salad stations, grill works and brick oven pizza, providing a smorgasbord of delectable options. Three full-service bars, including the “Donkey and Elephant Bar” behind home plate, will provide the perfect watering hole to cheer on the hometown team on a warm summer night in our nation’s capital.

### Features and Benefits:

- Club-level seating is limited to approximately 2,700 seats
- Private entry from the Stars and Stripes Club
- Three full-service bars
- HDTV monitors throughout the Club
- Panoramic views of the field and the waterfront
- Three sets of private restrooms within the Stars and Stripes Club
- Seats average 21" in width with a padded seat and slat back, within the Infield Skin
- Complimentary Nationals Yearbook sent during the season
- Opportunity to purchase playoff tickets
- Opportunity to purchase single-game tickets prior to public sale
- Exclusive Club Seat Holder events
- Plus all other amenities afforded to our traditional Season Ticket Holders

### Terms and Conditions:

All Club Seats are priced at \$45 or \$55 per ticket per game and require a \$300 per-seat deposit, due when submitting the Relocation Questionnaire, which must be returned by July 13, 2007.

View from Club Seats



Stars and Stripes Club



## TRADITIONAL SEATS

Season Ticket Holders at Nationals Park will find an incredible array of unique season ticket locations offering superior views in a variety of price ranges designed to meet every budget. Season Ticket Holders will be assigned their seats in Nationals Park based on their priority status, beginning with the Class of 2005. The seating diagrams on the following pages detail the specific locations and pricing structures for season ticket locations. Please use this chart as a reference tool as you complete your Relocation Questionnaire to indicate your seating preferences in Nationals Park. Outlined below are descriptions of many of the new and exciting seating offerings, most of which did not exist at RFK Stadium.

- *Dugout Boxes*: The best sightlines for traditional season tickets, located behind or adjacent to the home and visiting dugouts along the first and third base lines on the lower level.
- *Bullpen Seats*: Located directly behind or adjacent to the home and visiting team bullpens in Left and Right Field with great views to watch the pitchers warming up.
- *Center Field Club/Lounge*: The Center Field seats are one of a kind in Nationals Park with great sightlines, just behind the Center Field wall, combined with Club Seat amenities such as in-seat service, padded seats and access to the double-decker Center Field Restaurant and Bar, guaranteed to be where the action is on and off the field. The Center Field Lounge seats include a \$20 food and beverage credit per ticket per game, which can be used in the Center Field Restaurant.
- *Batter's Eye Box*: Our version of the "Green Monster Seats" in Boston's Fenway Park, these three rows of seats are located on a bridge that serves as the crossroad between the Center Field Restaurant and the "Scoreboard Walk" bar and entertainment deck in Center Field, destined to be in high demand in 2008.
- *Mezzanine Level*: Located along Left and Right Field on the Club Level, these seats offer some of the best views and price points on the mid seating level of the Ballpark.
- *Terrace Seating*: Situated on the Terrace Level in Right Field, these seats are one of the best bargains in the Ballpark, located in an area between the 3rd and 4th levels of the park.
- *Infield Gallery*: Panoramic views of the Ballpark provide incredible vantage points (and price points) for Nats fans.

### Features and Benefits:

- Guaranteed seats for every game, and the opportunity to purchase playoff tickets
- Discounts over single-game prices
- Season Ticket Exchange program along with bonus Season Ticket Holder programs such as My Nationals Tickets, Ticket Transfer and Ticket Replay—an exclusive account portal to be accessed only by Season Ticket Holders
- Access to exclusive Season Ticket Holder events
- Discount on Nationals merchandise
- Season Ticket Holder express service window at Nationals Park
- Complimentary Nationals Yearbook mailed during the season
- Opportunity to purchase single-game tickets prior to public sale

### Terms and Conditions:

Full Season Tickets require a \$300 per-seat deposit, Half Season Tickets require a \$150 per-seat deposit and Partial Season Tickets require a \$50 per-seat deposit. Deposits are due when submitting the Relocation Questionnaire, which must be returned by July 13, 2007.



## SEAT SELECTION PROCESS AND DEPOSIT INFORMATION

### Premium Seating Selection Process

All accounts that wish to purchase seats in the Premium Seating categories (Presidential and Diamond Seats) may indicate their preference to do so on the Relocation Questionnaire. The Customer of Record on the account will receive an invitation to come to the Nationals Sales and Marketing Center located in Washington Square (1050 Connecticut Avenue, NW, Suite 825, Washington, D.C. 20036) and personally select their seats, based on availability. This process will be used only for Premium Seating selections. All accounts that are purchasing Club Level and Traditional Seating will be notified of their seat locations in late fall 2007.

Accounts that wish to purchase Presidential Seats will be allowed to purchase up to four Full Season Presidential Seats in Nationals Park. In addition, those accounts purchasing Presidential Seats will also be allowed to purchase an equal number of Full Season Tickets in the Club Seats and/or Full, Half or Partial Season Tickets in the Traditional seating areas in Nationals Park as they have in their 2007 season ticket accounts. Please note that the Club and Traditional Seats will not be placed at the same time the Premium Seats are selected but rather at a later time, based on the Season Ticket Holder's account priority and the preferences indicated on the Relocation Questionnaire. Any season tickets added to an account after July 13, 2007, will be placed in Nationals Park at the end of the Class of 2007. The Customer of Record will be notified of all the account's seat locations in late fall 2007.

Accounts that wish to purchase Diamond Seats will be allowed to purchase the same number of Full Season Diamond Seats in Nationals Park as they have in their 2007 season ticket accounts. Those accounts purchasing Diamond Seats will also be allowed to purchase an equal number of Full Season Tickets in the Club Seats and/or Full, Half or Partial Season Tickets in the Traditional seating areas in Nationals Park as they have in their 2007 season ticket accounts. Please note that the Club and Traditional Seats will not be placed at the same time the Premium Seats are selected but rather at a later time, based on the Season Ticket Holder's account priority and the preferences indicated on the Relocation Questionnaire. Any season tickets added to an account after July 13, 2007, will be placed in

Nationals Park at the end of the Class of 2007. The Customer of Record will be notified of all of the account's seat locations in late fall 2007.

Accounts that wish to purchase Premium Seats will be invited to come to the Washington Nationals Sales and Marketing Center in order of priority, based on the criteria established in the Priority Relocation Process. The Customer of Record will be invited to select his/her seats in person. At the time the seats have been selected, accounts will be required to place a deposit of 20% of the total cost of the 2008 season tickets that are selected. Accounts will also be required to sign a Premium Seat Reservation Form, a precursor to the formal Seat License Agreement. If the Season Ticket Holder wishes to purchase any Full Season Club Seats and/or any Full, Half and/or Partial Season tickets in the Traditional Seating areas, a deposit for these seats will also be due when the Premium Seats are selected. The deposit for the Club and Traditional Seats is based on the type of Season Ticket Plan that is purchased:

Full Season Plan .....	\$300 per seat
Half Season Plan.....	\$150 per seat
Partial Season Plan.....	\$50 per seat

### Club and Traditional Seating Selection Process

All Club Seats and Traditional Seating locations will be assigned based on the criteria established in the Priority Relocation Process. Accounts who wish to purchase Club and/or Traditional Seats may do so by indicating their preference for these seats on their Relocation Questionnaire. When the Customer of Record submits the Relocation Questionnaire, a deposit per-seat will also need to be submitted. (Please note that both the Questionnaire and the deposit can be submitted either via mail or online.) The deposit is based on the type of Season Ticket Plan the account wishes to purchase in Nationals Park. The deposit amounts are listed below:

Full Season Plan .....	\$300 per seat
Half Season Plan.....	\$150 per seat
Partial Season Plan.....	\$50 per seat





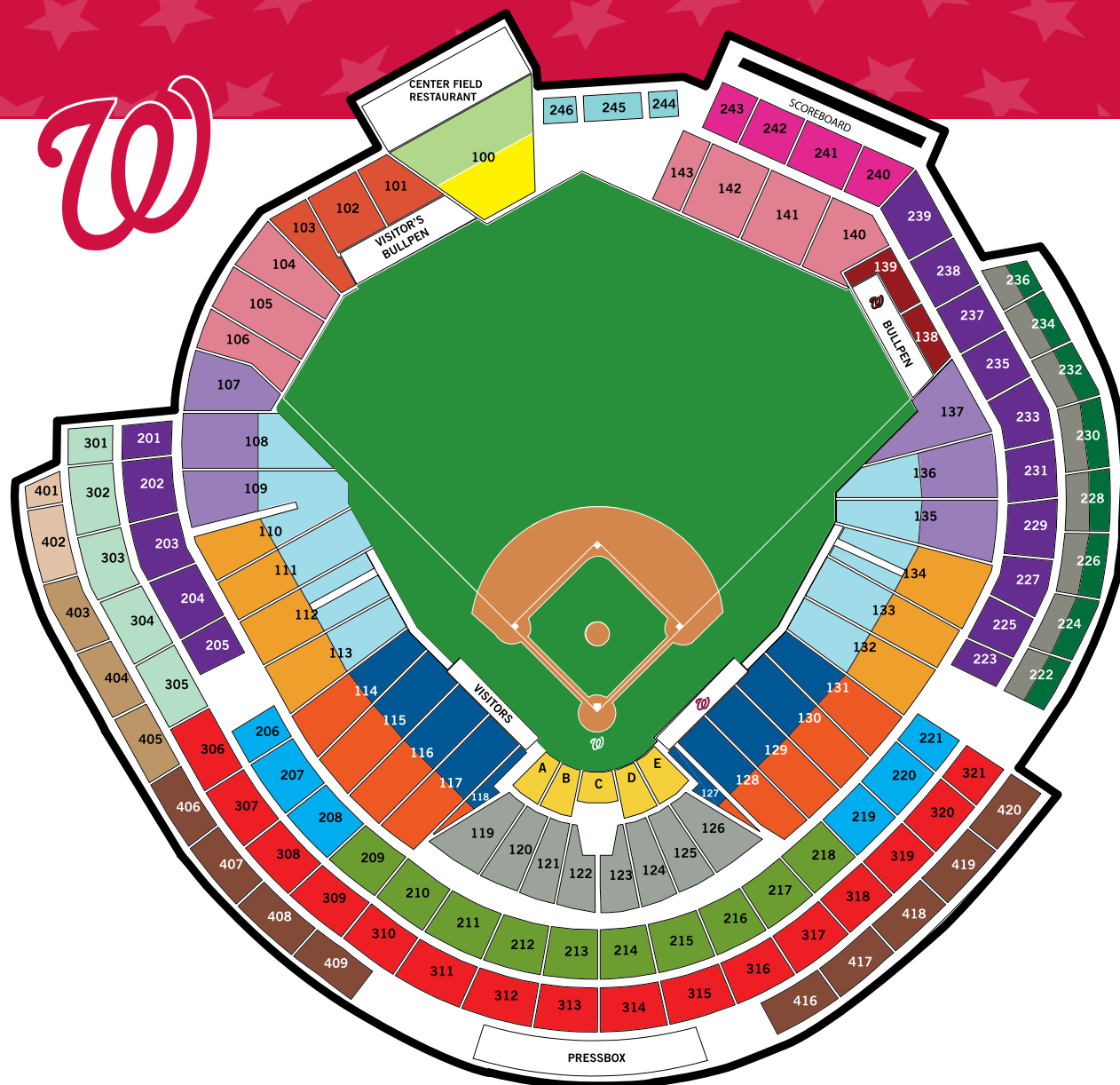

## NATIONALS PARK PRICING GUIDE AND SEATING DIAGRAM

Field Level	Full Season Plan	Half Season Plan	Partial Season Plan
Presidential Seats*	\$300	N/A	N/A
Diamond Seats	\$150	N/A	N/A
Home/Visitor Dugout Box	\$60	N/A	N/A
Home/Visitor Infield Box	\$50	N/A	N/A
LF/RF Baseline Box	\$45	N/A	N/A
LF/RF Baseline Reserved	\$40	\$42	\$44
LF/RF Corner	\$30	\$32	\$34
LF Bullpen	\$30	\$32	\$34
RF Bullpen	\$25	\$27	\$29
LF/RF Box	\$25	\$27	\$29
Center Field Lounge	\$60	N/A	N/A
Center Field Club	\$40	N/A	N/A
Club Level			
Infield Club	\$55	N/A	N/A
1st & 3rd Base Club	\$45	N/A	N/A

Mezzanine Level	Full Season Plan	Half Season Plan	Partial Season Plan
Batter's Eye Box	\$30	N/A	N/A
LF/RF Mezzanine	\$25	\$27	\$29
Scoreboard Pavilion	\$20	\$21	\$22
Terrace Level			
Lower Right Field Terrace	\$15	\$16	\$17
Upper Right Field Terrace	\$10	\$10	\$10
Gallery Level			
Infield Gallery	\$20	\$21	\$22
Outfield Gallery	\$15	\$16	\$17
Upper Gallery Level			
Upper Infield Gallery	\$15	\$16	\$17
Upper Outfield Gallery	\$10	\$10	\$10
Grandstand - \$5	N/A	N/A	N/A

(Grandstand seats available only for single-game purchases)

\*Call 202.675.NATS (6287) for front row pricing.

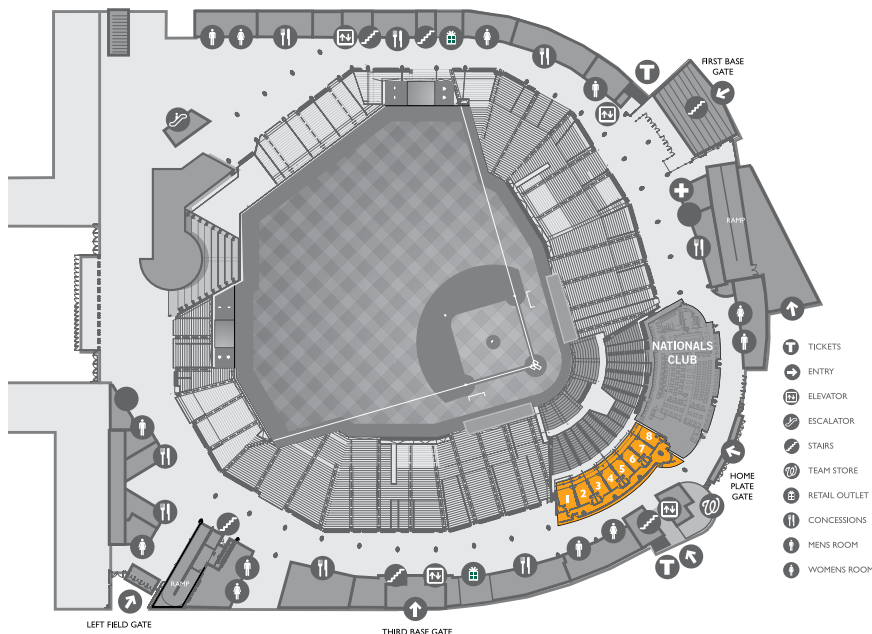

Washington Suites

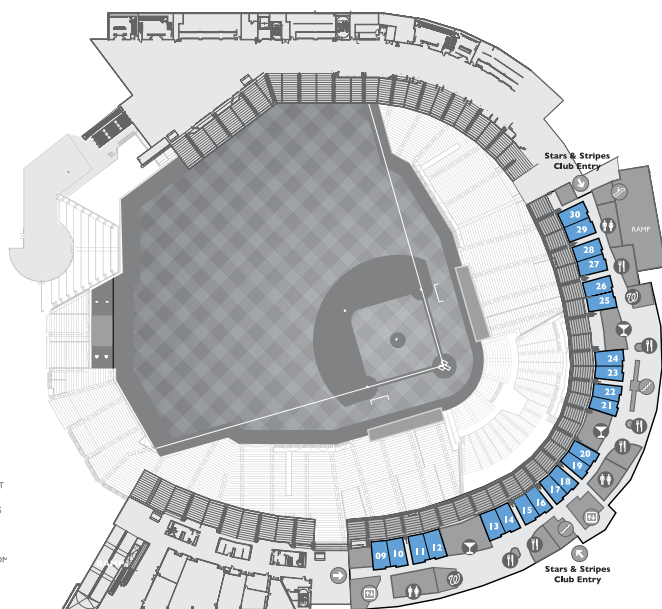

Lincoln Suites

## SUITE DESIGN INFORMATION

Baseball is a fiercely competitive sport. Making it to the big leagues requires a player to be at the top of his game. Likewise, suite ownership attracts individuals and organizations that have risen to the top of their particular fields of endeavor.

Leaders in business and government understand that suite ownership isn't an entertainment expense, it's a strategic investment. They appreciate that there's no better way to network, nurture employee morale or build valuable relationships than the three-hour bonding experience called baseball.

And suite usage isn't limited to baseball games. The suite is yours to use for meetings and gatherings throughout the year. Your intimate view of the field becomes a powerful business tool. With only 66 suites available to one of the most robust business communities in the world, demand for this limited number of suites will be competitive. In baseball, as in business, the most exciting opportunities often require immediate action. If you are interested in suite ownership, and what it can mean to your business or organization, please contact a member of our Premium Seating Department by calling 202.467.2008.

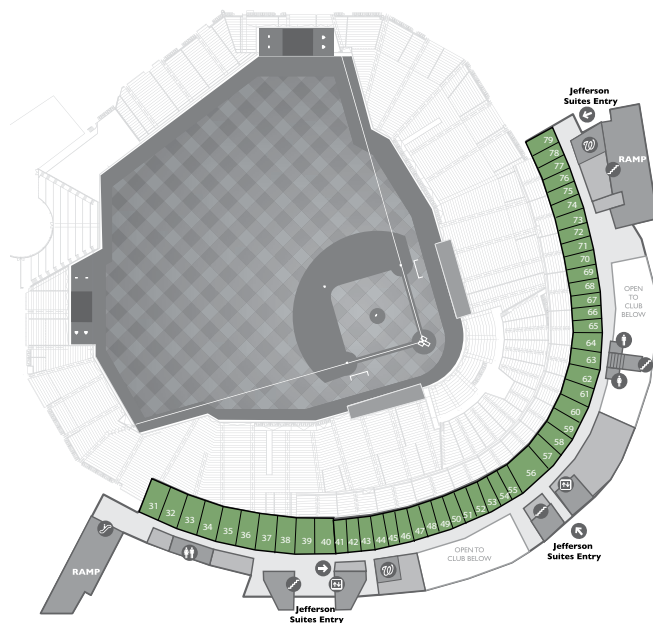

Jefferson Suites



## BALLPARK PARKING AND TRANSPORTATION

Nationals Park is located for maximum ease of access by Metro, car, bus, bicycle or on foot. An overview of the Ballpark area outlining the general road network from Washington, DC, suburban Maryland and Northern Virginia to the new Ballpark as well as the general street network around the Ballpark is shown below. Nationals Park is also well-served by the Metro system as can be seen by the listing of Metro lines in the map below. The Navy Yard Metro station, which is located just one block from the new Ballpark, is being expanded and should be ready by Opening Day 2008. Parking will be available at designated garages and surface lots and the Nationals are securing parking spaces near Nationals Park. The transportation program for Nationals Park will be communicated with details of both preferred and alternate transportation modes and routes as well as with specific and personalized parking locations together with the most direct path to get to each of them.



## NATIONALS PARK AND SEASON TICKET RELOCATION FREQUENTLY ASKED QUESTIONS

### Ballpark

- Q.** What side will the Nationals dugout be on?  
**A.** The first base side.
- Q.** What side of the park will be shaded?  
**A.** Seats along the Left Field line will be the most shaded in Nationals Park. For most of the season, all seats will be in the sun for a 1:00 PM start time. As the season moves along, the seats along the Left Field line, from Home Plate to the Foul Pole, will be in the shade for later afternoon and early evening start times.
- Q.** Are the Scoreboard Pavilion seats actually bleachers?  
**A.** No. All of the seats in Nationals Park are chairs with permanent backs.
- Q.** Where is the closest Metro stop to the Ballpark located?  
**A.** The Green Line runs to the Metro station at Navy Yard, located one block from the Ballpark, on the corner of Half and M streets. Please refer to the Ballpark Parking and Transportation section of this guide for more information.



### Relocation Process

- Q.** What is the relocation process based on?  
**A.** The primary priority criteria is account longevity, which is based on the number of continuous years that a customer of record has maintained the season ticket account. The secondary criteria include ticket plan size, seating category and the initial date and time of purchase. Please refer to the Priority Relocation Process section of the Relocation Guide for more detailed information regarding relocation priority.
- Q.** Who has priority in each class?  
**A.** Priority is based on account longevity, so accounts that have had the longest number of continuous years as a Season Ticket Holder will be seated first.
- Q.** How many tickets can I buy?  
**A.** Customers will be able to purchase the same number of seats in the new Ballpark as they have in their 2007 season account. Any 2007 season tickets that are purchased after July 13, 2007, will be seated in Nationals Park after the last account of the 2007 Class has been seated. The exceptions to this rule are accounts that are purchasing Premium Seats. Please refer to the Premium Seating section of this guide for more information regarding the number of Premium Seats an account can purchase.
- Q.** Can I upgrade my ticket plan and/or price category?  
**A.** Yes. Please indicate your preference to do so in the Relocation Questionnaire. You will be assigned seats based on your priority order and then by the type of ticket plan you have requested.
- Q.** What locations will be available for Half and Partial plans?  
**A.** Half and Partial locations will be based on availability after Full season ticket locations have been assigned for each class. These seating locations have not yet been determined and may not be available in all of the price categories in the new Ballpark. Please refer to the Relocation Questionnaire (located in the back page pocket of this guide) for a list of potential available seating locations. Half and Partial Season Ticket Plans are not offered in the Presidential, Diamond and Club seats.





6. **Q.** I have seats in multiple locations. Will all of my seats be placed at the same time? And do I need to fill out a Questionnaire for each location?
- A.** Your seats will be placed at the same time, but you will still be required to fill out a Relocation Questionnaire for your multiple locations. Please refer to the instructions in the Questionnaire regarding multiple seat locations for more information.
7. **Q.** When will I find out my seat location?
- A.** During late fall of 2007.
8. **Q.** What happens if I don't fill out a Relocation Questionnaire or pay the deposit?
- A.** If no Questionnaire is filled out, seats will be placed in a location that is similar in price range and location to your current RFK Stadium location. If no deposit is received by July 13, 2007, the season ticket account will NOT be relocated.
9. **Q.** Can I submit my form/deposit online?
- A.** Yes. Please go to [nationals.com/relocation](http://nationals.com/relocation) and follow the steps online.
10. **Q.** I have a partner who has always shared my season tickets. Can my partner purchase tickets in his/her own name now and receive the same priority that I have and be seated at the same time my seats are placed in Nationals Park?
- A.** No. Only official customers of record are eligible to participate in the relocation process. The Nationals will, at their sole discretion, determine the customer of record for each season ticket account. Existing account partners who wish to become customers of record and purchase season tickets in their own names will be accommodated at the end of the relocation process, before we begin seating new season customers. Existing account partners will be accommodated after customers of record have had the opportunity to purchase additional seats in Nationals Park, above the number they currently hold at RFK Stadium.
11. **Q.** How can I sit near my friends?
- A.** Indicate your preference to do so on the form, and provided your request is consistent with theirs, we will do our best to accommodate you. However, other aspects of your seat location may be compromised to accommodate this request.
12. **Q.** What if I decline to buy seats now but want to buy at a later date?
- A.** You may purchase tickets at a later date; however, your priority as a Season Ticket Holder will no longer be a factor and selection of available seats will likely be compromised.
13. **Q.** Who will make the decisions regarding my seat location?
- A.** Season Ticket Holders' preferences are a determining factor in seat assignments. Based on the established criteria in the Relocation Philosophy, a team of Nationals staff will work to locate you into seats that best match your preferences.
14. **Q.** Why can't I be assigned the same seats in Nationals Park that I currently have in RFK Stadium?
- A.** The design and configuration of Nationals Park are completely different from RFK Stadium, therefore, no two sections are exactly alike. You will have the opportunity to state your seating preferences on the Relocation Questionnaire for the location that best fits your needs.

### Seat Location

1. **Q.** Will I be able to get an idea of what sightlines are from different seats?
- A.** Yes. We have created 3D virtual sightlines for all sections of the new Ballpark on the Nationals website. Simply go to [nationals.com/relocation](http://nationals.com/relocation) and click on the "3D View" icon to see these sightlines.



2. **Q.** Where will my seats be located?  
**A.** Due to the baseball-specific design of Nationals Park, most seating locations will not correspond exactly to RFK Stadium. However, by indicating your preferences on your Questionnaire, we will do our best to place you in the most comparable location with the best sightlines to fit your needs.
3. **Q.** What do I need to do if I have any physical needs that must be accommodated?  
**A.** Please be sure to note your needs on the Relocation Questionnaire so we can do our best to accommodate you. Nationals Park will have more elevators, wider concourses and easier access to seating than RFK Stadium. These amenities will generally provide you with more seating options than ever before.
4. **Q.** If I am in the front row in RFK Stadium, will I be in the front row in Nationals Park?  
**A.** Your Relocation Questionnaire provides the opportunity to indicate your detailed seating preferences. However, factors such as the configuration of the Nationals Park (longer dugouts, fewer front-row seats) and designated sections for Full Season Plans only will also determine your seat location. And disabled access seating has been provided in the front rows of many sections in the new Ballpark. All of these issues may have an impact on where your seats are located in Nationals Park.
5. **Q.** Will I be on the same row I am currently on in RFK Stadium?  
**A.** Nationals Park will have an entirely different structure than RFK Stadium. Although you may not be able to obtain seats identical to your current location, you will be given the opportunity to state your seating preferences on your Relocation Questionnaire for the location that best fits your needs.
6. **Q.** Will I be guaranteed an aisle seat?  
**A.** Indicating “Aisle Seat” as your number one preference on the Questionnaire will help in obtaining this location at Nationals Park, but we cannot guarantee that you will receive an aisle seat. Be sure to check the box on the Questionnaire indicating that you currently have an aisle seat. However, other aspects of your seat location may be compromised to accommodate this preference.
7. **Q.** Will I get to sit in a specific section that I want?  
**A.** We will do our best to fulfill your seating preferences, but we cannot guarantee that you will be placed in a specific section in Nationals Park.
8. **Q.** Will my location be affected if I add on more seats after July 13, 2007?  
**A.** Seats that are purchased after July 13, 2007, will be placed in Nationals Park after the last account of the Class of 2007 has been seated. However, if you would like to have all of your seats assigned at the same time, based on your original account priority, all seats must be paid in full by July 13, 2007.

### **Premium Seating**

1. **Q.** What is a “Premium Seat”?  
**A.** A Premium Seat is a seat that has a contractual obligation tied to it. The Premium Seats in Nationals Park are in the sections located in the Presidential and Diamond Seats.
2. **Q.** How do I purchase a Premium Seat?  
**A.** Please indicate your preference to purchase a Premium Seat on the Relocation Questionnaire. All accounts that request premium seating will be contacted at a later date regarding the options that are available in the Premium sections.
3. **Q.** Can I purchase Premium Seats and Traditional Seats?  
**A.** Yes. Please indicate on your Relocation Questionnaire your preference to purchase both Premium and Traditional Seats. (Traditional Seating includes tickets in the Club Level, which do not require a multi-year agreement.)







Washington Nationals  
Sales & Marketing Center  
Washington Square  
1050 Connecticut Avenue, N.W.  
Suite 825  
Washington, D.C. 20036

202.675.NATS (6287)  
[nationals.com](http://nationals.com)